



HUDCO DESIGN AWARDS 2021-22

- Cost Effective Rural / Urban Housing Deploying Innovative / Emerging & Disaster Resistant Technology
- New and Innovative Town Design Solution / Eco-cities
- Conservation of Heritage
- Green Building
- Landscape Planning and Design

Category: 5
Landscape Planning & Design

Project:
SRM University AP, Phase-I, Amaravati

By
Ravikumar and Associates



SECOND PRIZE

LOCATION MAP

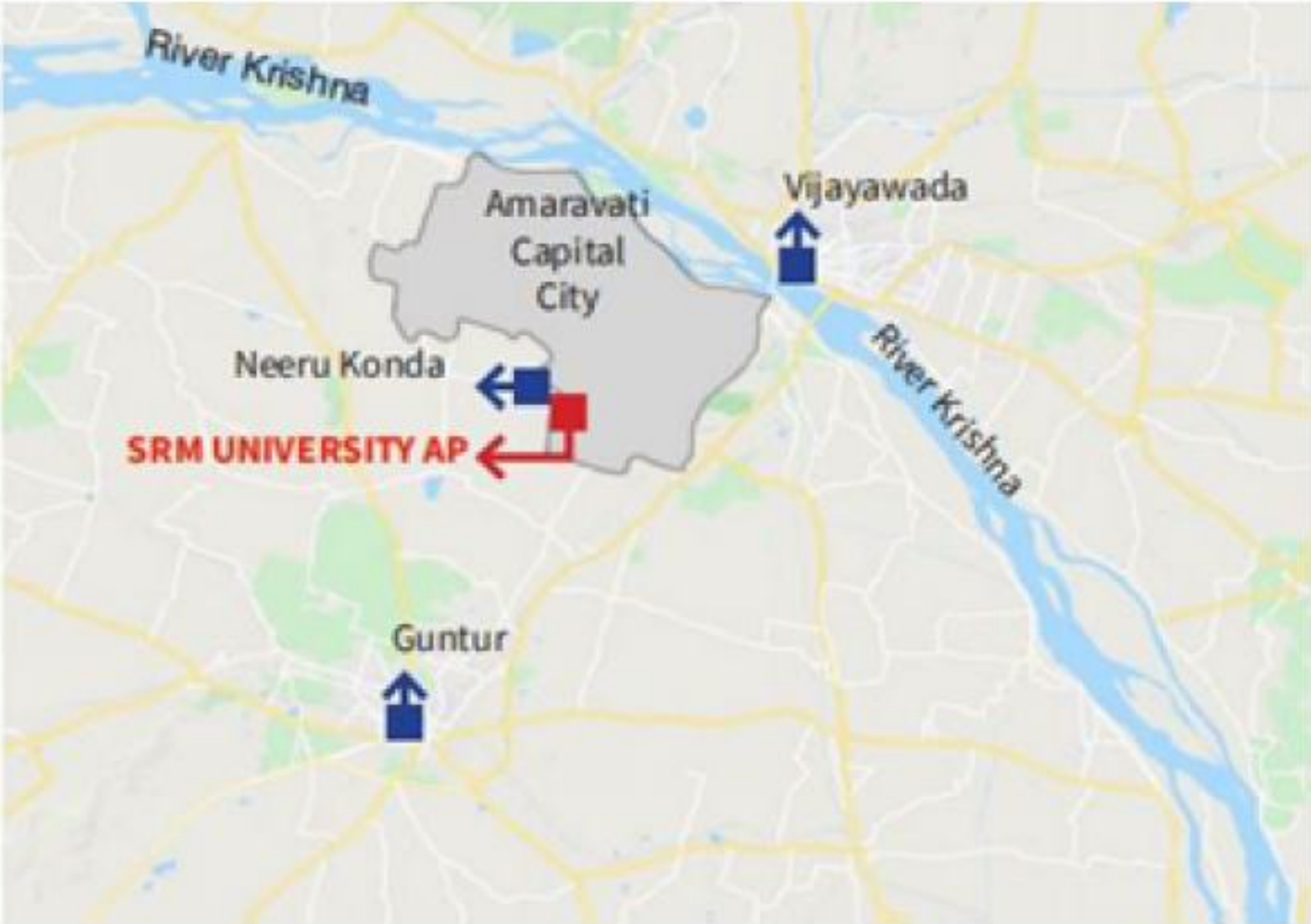

AMARAVATI CAPITAL CITY ZONING PLAN

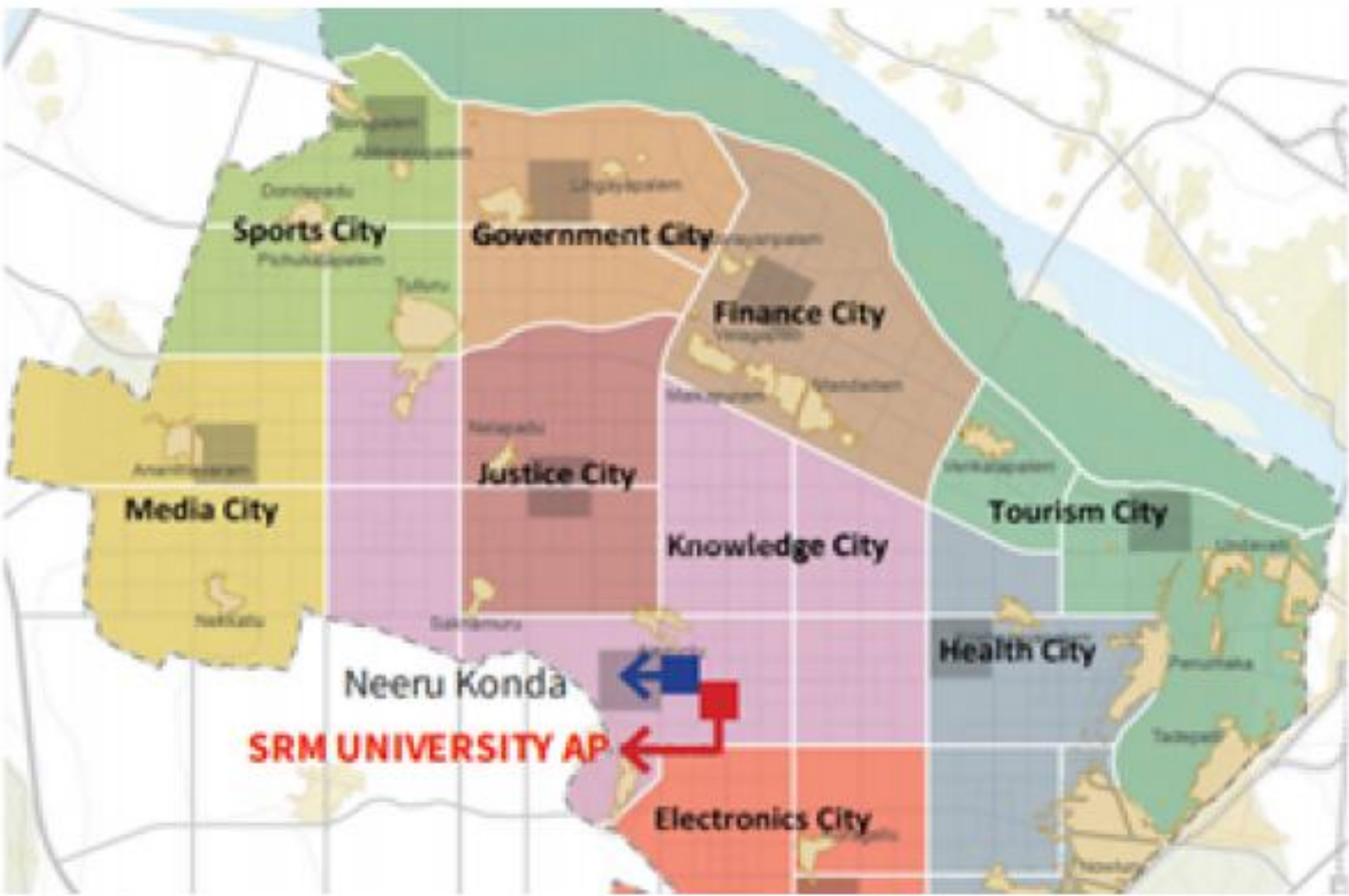

SURROUNDING LANDUSE



Legend

- Institutional Zone
 - Commercial zone
 - The Site
 - Open Spaces
 - Residential Zone
 - Road
- The site for the proposed SRM University AP is located at the 'Knowledge City' of the Proposed Amaravati Capital City. The extent of the site is 200 acres and is to be developed in phases. The Phase I development has been proposed in 20 acres of land extend to have admin, academic, and housing requirements.



SRM UNIVERSITY AP, PHASE - I, AMARAVATI

MASTER PLAN (200 ACRES)



- Central Park
- Academic
- Iconic
- Residential
- Utility
- Parking

The Phase I campus site (20 acres) has been selected at the North East corner of the 200 acre campus. This is done in order that there is no conflict of the Phase I campus with the overall master plan and also not to conflict with future construction activities.

Legend

- Entrance zone
- Rain tree zone
- Food zone
- Housing zone
- Academic and Admin block
- Hostel block
- Utility and Food court
- Vehicular roads
- Pedestrian pathway

PHASE - I ZONING PLAN

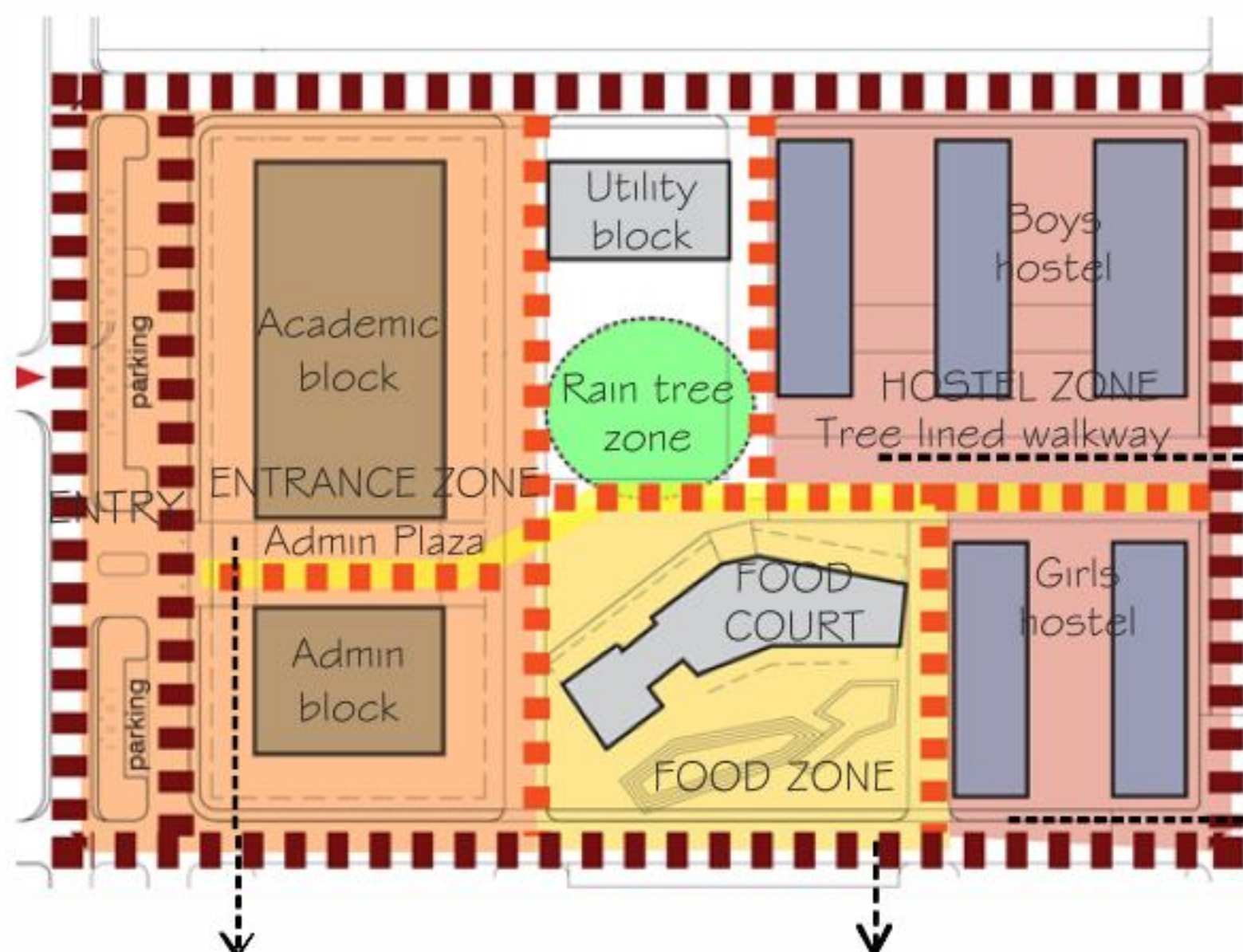

The hierarchy of landscape spaces right from the entrance court, Academic Plaza, Tree Court upto the Streetscapes leading to hostels provide a seamless physical connectivity as well as an aesthetic spatial experience.

The Landscape Design Takes a contemporary approach and facilitates a complete system of pedestrian spaces throughout, while the vehicular movement is restricted to periphery.

The Central Tree Court, the most happening place with the play zone and seat courts connecting all the other spaces.

A large lawn area defined by gathering space at the rear of the dining.

The Program for Phase I required an Academic Zone, Food Zone, Housing Zone and a Rain tree Zone (Student Interaction Zone).

SRM UNIVERSITY AP, PHASE - I, AMARAVATI

PHASE - I MASTER PLAN



DESIGN PROGRAM

ACADEMIC ZONE

- Admin Block
- Academic Block
- Parking and Driveways
- Accent element with signage
- Water Feature
- Admin Plaza with Lawn Strips
- Seating Spaces
- Terrace Gardens

RAIN TREE ZONE

- Basket Ball Court
- Stepped Seating (Students Gathering Space)
- Tree Court
- Seating Spaces

FOOD ZONE

- Dining Court
- Lawn
- Deck
- Stepped Seating (Students Gathering Space)
- Terrace Gardens

HOUSING ZONE

- Housing for Boys
- Housing for girls
- Seat Court
- Paved Court
- Walkways
- Stepped Seating (Students Gathering Space)
- Terrace Gardens

SRM UNIVERSITY AP, PHASE - I, AMARAVATI

ACADEMIC BLOCK



- The main street originates in this zone and passes through the admin and academic blocks connecting them with the Rain tree zone.
- The main street in the zone comprises of pedestrian plazas, berms, planting and water feature.

Plan



SRM UNIVERSITY AP, PHASE - I, AMARAVATI

RAIN TREE ZONE



- This is the student interaction zone and is the focal point of the entire campus.
- It is designed as an 'Indian Village Square' with a tree court as its focal point and streets passing through it. It thus becomes a node connecting the academic, food and housing zones.
- It includes both active and passive recreation areas.

Plan



SRM UNIVERSITY AP, PHASE - I, AMARAVATI

FOOD ZONE

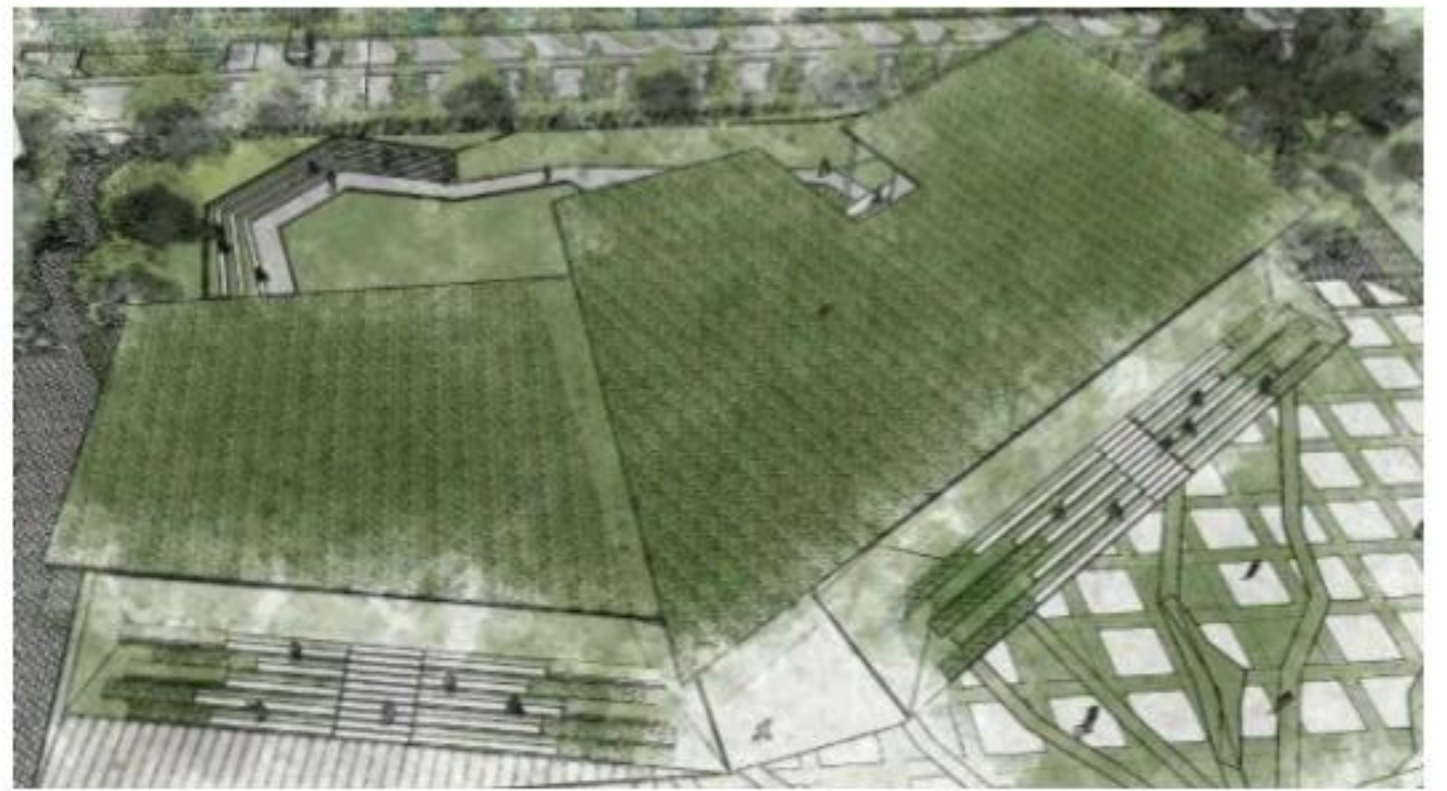

- Comprises of a dining block which is a sustainable building with a green roof.
- The rear side comprises of a large lawn for gathering and a stepped seating space.
- The front has a seating gallery overlooking the Rain tree zone.

Plan



SRM UNIVERSITY AP, PHASE - I, AMARAVATI

HOUSING ZONE



- The main street culminates in the housing zone and it comprises of boys hostels and girls hostels overlooking it.
- It has bicycle pathways, informal seating spaces for student interaction and tree lined walkways.

Plan



SRM UNIVERSITY AP, PHASE - I, AMARAVATI

LEVEL UP ZONE



- Interesting terraces have been created at various levels both in the hostel and academic blocks.
- These create the essential break - out spaces for students, housing cafes, seating spaces and self - study spaces.



SRM UNIVERSITY AP, PHASE - I, AMARAVATI

SUSTAINABLE DESIGN PRACTICES

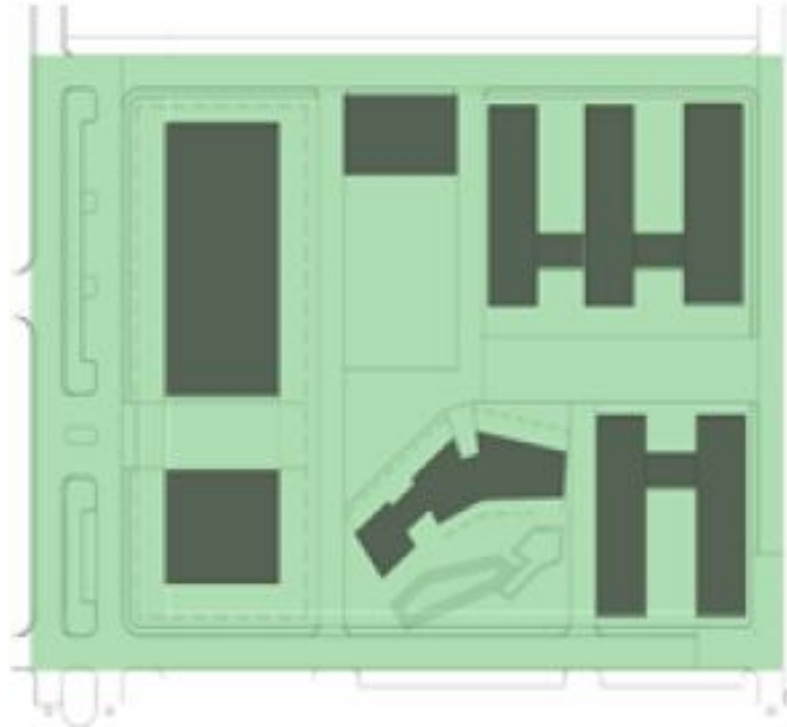

Green Area Ratio

70% of the site area are open spaces thus increasing the green area ratio.



Well Shaded Spaces

Evergreen trees have been proposed to shade the seat courts, paved areas to minimize the heat island effect.



Local & Native Species

Local and drought tolerant tree species have been planted throughout the site.

SALIENT FEATURES

- All areas have been designed to be disabled friendly, through the use of ramps.
- Different species of native plants and trees planted to encourage bio-diversity.
- Bioswale along the periphery of the site.
- Existing natural gradient of the site is retained



Green Roof

Few buildings are provided with green roof for heat island mitigation.



Locally Available Materials

Locally available granite is extensively used for curbs, seatings and other landscape elements.



Materials

Semi-pervious and grass pavers have been extensively used for the walkways and driveways for water percolation.

WATER CONSERVATION

- Water from sewage treatment plant is used for irrigation.
- Irrigation through drips and micro sprinklers



Housing & Urban Development Corporation Ltd.

(A Government of India Enterprise)

HUDCO Bhawan, Core 7A, India Habitat Centre, Lodhi Road, New Delhi – 110003

Tel: 24649610-23, 24627113-15, **Fax:** 011-24625308

Website: www.hudco.org.in

CIN: L74899DL1970GOI005276

GSTN: 07AAACH0632A1ZF